



## HTM-1990R 19-inch HDTV/SDTV Multi-format Color Monitor

RoHS

Master Monitor



A new flat surface high resolution CRT with 0.25mm dot pitch and newly developed video processing circuitry are employed to achieve master monitor picture quality. Optional multi-SDI Modules accept HD-SDI or SD-SDI by auto detection.



- 19-inch
- Flat-face
- 950TVL
- VBS Input
- Y, P<sub>b</sub>, P<sub>r</sub>/RGB Input
- HD/SD-SDI Input
- Embedded AES/EBU Output
- Embedded Analog Audio Output
- Embedded Audio Indicator
- 4:3/16:9
- HD4:3 zoom
- Remote (Parallel)
- Remote (Serial)
- Remote (Infrared rays)
- Auto Set-up
- Marker
- Shadow
- Test Signal Generator
- 4-Color-temperature-memory
- Chroma Up +12 dB
- 4-Plug-in
- W450.0xH399.0xD515.0mm (W17.8xH15.8xD20.3inches)
- 9RU
- 37kg (81.57lbs)
- 16:9mask

## HTM-1917R 19-inch HDTV/SDTV Multi-format Color Monitor

RoHS

High-End Broadcast Monitor



8ch Embedded Audio Level Indicator



A new flat surface and High Resolution CRT is employed to achieve superb picture. Optional multi SDI Modules have been developed for the HTM series Multi-Format monitors. These modules accept HD-SDI or SD-SDI by auto detection. Also equipped with Embedded Audio Outputs (Analog or AES/EBU) and Audio Level Indicators. (8ch)



- 19-inch
- Flat-face
- 900TVL
- VBS Input
- Y, P<sub>b</sub>, P<sub>r</sub>/RGB Input
- HD/SD-SDI Input
- Embedded AES/EBU Output
- Embedded Analog Audio Output
- Embedded Audio Indicator
- 4:3/16:9
- HD4:3 zoom
- Remote (Parallel)
- Remote (Serial)
- Remote (Infrared rays)
- Auto Set-up
- Marker
- Shadow
- Test Signal Generator
- 4-Color-temperature-memory
- 4-Plug-in
- W450.0xH399.0xD515.0mm (W17.8xH15.8xD20.3inches)
- 9RU
- 37kg (81.57lbs)
- 16:9mask



## HTM-1517R 15-inch HDTV/SDTV Multi-format Color Monitor

RoHS

High-End Broadcast Monitor

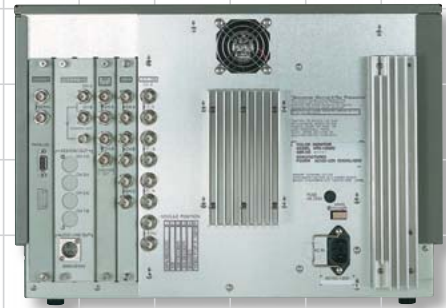

Ikegami's high-end Color Monitor Series with cost effective offers a choice of 15-inch monitor to meet not only every HDTV format, but also SDTV standards. Designed for diverse broadcasting formats and system requirements, the Color Monitors offer compatibility with HDTV/SDTV analog component signals (Y, P<sub>B</sub>, P<sub>R</sub> / RGB) as standard. Serial digital input compatibility is optionally available.

<b>15-inch</b>	<b>750TVL</b>				
<b>VBS Input</b> ▲	<b>Y, P<sub>B</sub>, P<sub>R</sub> / RGB Input</b>	<b>HD/SD-SDI Input</b> ▲	<b>Embedded Audio Indicator</b> ▲	<b>Embedded AES/EBU Output</b> ▲	<b>Embedded Analog Audio Output</b> ▲
<b>4:3/16:9</b>	<b>HD4:3 zoom</b>	<b>Remote (Parallel)</b>	<b>Remote (Serial)</b>	<b>Remote (Infrared rays)</b>	<b>Auto Set-up</b>
<b>Marker</b>	<b>Shadow</b>	<b>Test Signal Generator</b>	<b>4-Color-temperature-memory</b>		
<b>4-Plug-in</b>	<b>W450×H310×D515mm (*17.8×12.2×20.3 inches)</b>	<b>7RU</b>	<b>28kg (61.73lbs)</b>		

▲ Option

# Evolutional Feature for HTM-Series Multi-format Monitors

## Multi-Embedded SDI Input

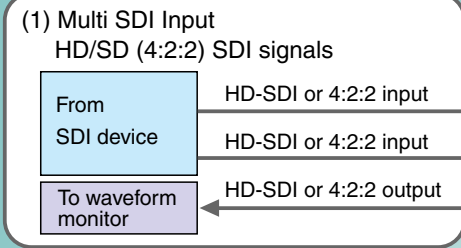

(2) Embedded AES/EBU 8-channel  
(CH1/2, 3/4, 5/6, 7/8) output

(3) Embedded Analog Audio 2-ch Output  
(CH1/2, 3/4, 5/6, 7/8):  
selectable by menu

HTM-1517R/1917R/1990R

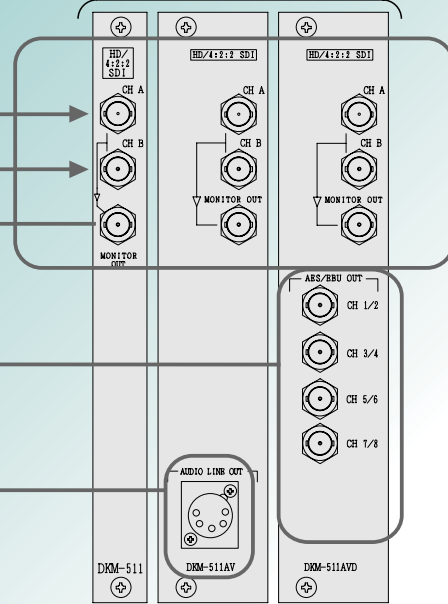

## Multi-Embedded Audio Level Indicator

The audio level indicator can be mounted on the escutcheon this provides elimination of CRT burn-in and high visibility in a space saving design. Both video and audio levels can be monitored.

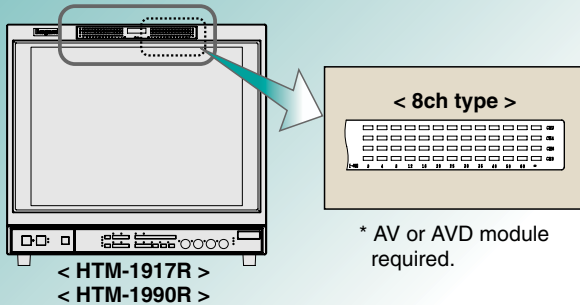

## HDTV 4:3 Area Zoom Function

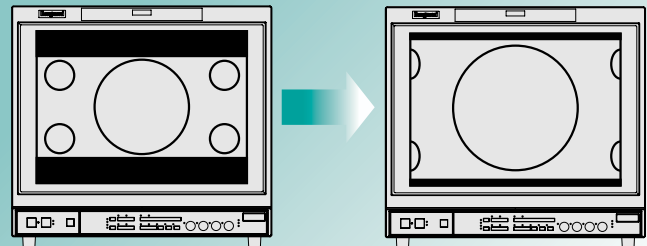

Enlarging a 16:9 image until it fills the height of the 4:3 screen increases resolution and image size.

[Model]	16:9	4:3
HTM-1517R:	15"	19"
HTM-1917R/1990R:	19"	24"

## Optional Accessories for HTM-series Monitors

### HTM1990R/1917R/1517R

Model	Description	Remarks
DKM-511A	Multi-SDI 2 Input Module (HD-SDI/SD-SDI)	SDI: 2 Inputs/1 Outut (High performance)
DKM-511A-AV	Multi-SDI 2 Input and Embedded Audio Output Module	SDI: 2 Inputs/1 Outut, 2ch Embedded Analog Audio Outputs
DKM-511A-AVD	Multi-SDI 2 Input and Embedded AES/EBU Output Module	SDI: 2 Inputs/1 Outut, 8ch Embedded AES/EBU Outputs
DKM-511B	Multi-SDI 2 Input Module (HD-SDI/SD-SDI)	SDI: 2 Inputs/1 Outut (Standard performance)
DAM-518	8ch Embedded Audio Level Indicator	Requires DKM-511A-AV/AVD for use
DK-801A	SD-SDI Input Module	SD SDI 4:2:2 digital component, 2 Inputs / 2 Outputs
DE-801	NTSC 3-line Comb Decoder Module	VBS(NTSC): 3 Inputs / 3 Outputs (Sampling Rate:27MHz)
DE-811	NTSC/PAL Decoder Module	(Sampling Rate:14.3MHz)
EX-801A	Test Extender Board	
RCT-30A	Infrared Remote Controller	
SRC-301Z	Serial Remote Controller	Controls up to 99 monitors with loop through connection
MK-1905	16:9 Mask for 19-inch Monitor	Easy attachment/deattachment to bezel
ASP-100	Auto setup Probe	Auto-adjustment of color temperature
A-TM20-16	Rack-mount hardware for 19-inch monitor	(Same as RS-2020)
A-TM15-50	Rack-mount hardware for 15-inch monitor	(Same as RS-1550)
TTM-20	Monitor slide rail for 19-inch/15-inch monitor	



## TM20-80RH 20-inch High Quality Broadcast Color Monitor

SDTV Master Monitor



The 80 series color monitors are designed to be high-end Grade-I master monitors to succeed Ikegami's monitors which have been established as state-of-the art technology of conventional broadcasting. With the superior technology and confidence kept, further improvement for performance are achieved in this new series monitor to satisfy more flexible applications.



- 20-inch
- 700TVL
- VBS Input
- Y, P<sub>s</sub>, P<sub>R</sub>/RGB Input
- SD-SDI Input ▲
- 4:3/16:9
- Remote (Parallel)
- Remote (Serial)
- Remote (Infrared rays)
- Auto Set-up
- Marker
- Shadow
- Self-contained Chart
- 4-Color-temperature-memory
- 4-Plug-in
- W450.0xH399.0xD515.0mm (W17.8xH15.8xD20.3inches)
- 9RU
- 38kg (83.78lbs)

## TM15-70R 15-inch Color Monitor

Broadcast Monitor



Ikegami 70 Series are High performance, Low cost color SDTV Monitors, providing NTSC-PAL automatic selection. The Units are specifically designed for production or broadcast applications, and provide high-fidelity video reproduction with easy operation, utilizing In-Line Gun CRT technology, BFS circuits, and Comb filter (NTSC only). The 17 Series Color Monitors can accept 2 composite video, Y/C, and RGB or Component inputs in both NTSC and PAL formats. Furthermore, Digital Inputs (D1, D2, D3 formats) are available with optional modules and also it employs the In-line gun, Dot-shadow mask, high resolution CRT.

- 15-inch
- 650TVL
- VBS Input
- Y/C Input
- Y, P<sub>s</sub>, P<sub>R</sub>/RGB Input
- SD-SDI Input ▲
- 4:3/16:9
- Remote (Parallel)
- W450.0xH310.0xD515.0mm (W17.8xH12.2xD20.3inches)
- 7RU
- 24kg (52.9lbs)

### Optional Accessories for TM-series Monitors

▲ Option

#### TM20-80RH

Model	Description	Remarks
DK-801A	SD-SDI Input Module	SD SDI 4:2:2 digital component, 2 Inputs / 2 Outputs
DE-801	NTSC 3-line Comb Decoder Module	VBS(NTSC): 3 Inputs / 3 Outputs
DE-811	NTSC/PAL Decoder Module	
EX-801A	Test Extender Board	
RCT-30A	Infrared Remote Controller	
SRC-301Z	Serial Remote Controller	Controls up to 99 monitors with loop through connection
ASP-100	Auto setup Probe	Auto-adjustment of color temperature
A-TM20-16	Rack-mount hardware for 19-inch monitor	(Same as RS-2020)
TTM-20	Monitor slide rail for 19-inch/15-inch monitor	

#### TM15-70R

Model	Description	Remarks
DK-175	SD-SDI Input Module Kit for TM15-70R	
A-TM15-50	Rack-mount hardware for 15-inch monitor	(Same as RS-1550)
TTM-20	Monitor slide rail for 19-inch/15-inch monitor	
RCT-30A	Infrared Remote Controller	
SRC-301Z	Serial Remote Controller	Controls up to 99 monitors with loop through connection



RoHS

Broadcast Monitor

RoHS

Broadcast Monitor

## HTM9-1D 9-inch HDTV Professional Color Monitor



The HTM9-1D is designed with professional feature to satisfy the demanding needs of broadcast and video industries, this HDTV monitor is small in size yet big on performance. And best of all, it's very affordable.

9-inch

NTSC/PAL

HD/SD-SDI Input

Embedded AES/EBU Output

Embedded Audio Indicator

4:3/13:9/16:9

Zoom

Area Marker

Remote (Serial)

W222x220x360.2mm  
(8.7x8.6x14.2 inches)

5RU

7.8kg  
(17.2lbs)

## TM9-3/TM9-3D 9-inch Color Monitor



The TM9-3 Series monitor offers NTSC / PAL multi-format compatibility, selectable 4:3 / 16:9 aspect ratio, preset-table controls, two video and audio inputs, and operates from virtually any AC source from around the world. It is a rugged top performer that you can take anywhere with confidence. The TM9-3D model has a built-in Serial Digital Component input.

9-inch

300TVL

DC Input

Battery

VBS Input

Y/C Input

VBS Input

SD-SDI Input

4:3/16:9

Remote (Parallel)

W222x236x317mm  
(8.8x9.3x12.5 inches)

5RU

7.4kg  
(16.03lbs)

7.9kg  
(17.04lbs)

## VCM-1501 14-inch Color Monitor



The VCM-Series high performance monitors are designed for various monitoring requirements such as professional use at broadcasting and production facilities, corporate video and educa-

tional TV systems. With using color switching system, NTSC/PAL can be selected by auto detection.

14-inch

700TVL

VBS Input

Y/C Input

Audio input (RCA)

Speaker

W356x333x381mm  
(14x13.1x15 inches)

8RU

15.7kg  
(34.6lbs)

## VCM-901 9-inch Color Monitor



The VCM-Series high performance monitors are designed for various monitoring requirements such as professional use at broadcasting and production facilities, corporate video and educational TV systems. With using color switching system,

NTSC/PAL can be selected by auto detection. Two units with optional mounting kit fit in 19inch rack-mount.

9-inch

300TVL

VBS Input

Y/C Input

Audio input (RCA)

Speaker

W220x223x317mm  
(8.66x8.78x12.48 inches)

5RU

7kg  
(15.4lbs)

## HPM-9050 9-inch HDTV Monochrome Monitor



Ikegami's HPM-9050 9-inch High Definition Monochrome Monitor with a High Resolution CRT delivers over 800 lines of horizontal resolution. Switching power supply circuitry provides a wider range of supply voltages, while its back porch clamp assures consistent stability for the video black level. The HPM-9050 can be combined with a WFM monitor and/or vectorscope, and also mounted in a 19-inch rack with a two-monitor configuration. The HPM-9050 is ideally suited for use in applications such as signal monitoring and adjustment for video equipment installed in broadcasting facilities.



9-inch

800TVL

Analog Y or RGB Input

4:3/16:9

Remote (Parallel)

4:3 Scan

W220x215x255mm  
(8.7x8.5x10.1 inches)

5RU

7.5kg  
(16.53lbs)

# CRT Monitors Specifications



	CRT Size (Viewing Area)	Rack-mountable Space	Resolution	Dot Pitch	Input Signal							Tally		Power Consumption	Dimensions mm (inch)	Weight kg (lbs)	
					VBS	Y, Pb, Pr/RGB	Y/C	Multi-SDI	SD-SDI	Embedded Audio	Analog Audio	DC Input	R				G
<b>HTM-1990R</b>	19"	9 RU	950TVL	0.25mm	△ 3	○ 1	×	△ 2	△ 2	△ 2	×	×	○	○	240 W	W450 (17.8) × H399 (15.8) × D515 (20.3)	37kg (81.57 lbs)
<b>HTM-1917R</b>	19"	9 RU	900TVL	0.25mm	△ 3	○ 1	×	△ 2	△ 2	△ 2	×	×	○	○	240 W	W450 (17.8) × H399 (15.8) × D515 (20.3)	37kg (81.57 lbs)
<b>HTM-1517R</b>	15"	7 RU	750TVL	0.27mm	△ 3	○ 1	×	△ 2	△ 2	△ 2	×	×	○	○	240 W	W450 (17.8) × H310 (12.2) × D515 (20.3)	28kg (61.73 lbs)
<b>HTM-9-1D</b>	9"	5 RU	230TVL (HD) 300TVL (SD)	0.5mm	○ 2	×	×	○ 2	—	○ 2	×	×	○	○	45W	W222 (8.7) × H220 (8.6) × D360.2 (14.2)	7.8kg (17.2 lbs)
<b>TM20-80RH</b>	20"	9 RU	700TVL	0.43mm	○ 3	○ 1	×	×	△ 2	×	×	×	○	○	160 W	W450 (17.8) × H399 (15.8) × D515 (20.3)	38kg (83.78 lbs)
<b>TM15-70R</b>	15"	6 RU	650TVL	0.28mm	○ 2	○ 1	○ 1	×	△ 2	×	×	×	○	×	60W	W450 (17.8) × H310 (12.2) × D515 (20.3)	19kg (41.89 lbs)
<b>TM9-3/TM9-3D</b>	9"	5 RU	300TVL		○ 2	×	×	×	×	×	×	○	○	○	40W	W222 (8.8) × H236 (9.3) × D317 (12.5)	7.4kg (16.03 lbs)
					○ 2	×	×	×	○ 2	○ 2	×	×	○	○	40W	D317 (12.5)	7.9kg (17.04 lbs)
<b>VCM-1501</b>	14"	8 RU	700TVL		○ 2	×	○ 1	×	×	×	○ 1	×	×	×	80W	W356 (14) × H333 (13.1) × D381 (15)	15.7kg (34.6 lbs)
<b>VCM-901</b>	9"	5 RU	300TVL		○ 2	×	○ 1	×	×	×	○ 1	×	×	×		W220 (8.66) × H223 (8.78) × D317 (12.48)	7kg (15.4 lbs)
<b>HPM-9050</b>	9"	5 RU	800TVL		×	○ 1	×	×	×	×	×	×	○	×	60W	W220 (8.7) × H215 (8.5) × D255 (10.1)	7.5kg (16.53 lbs)

△ Option