

MA-200A

PARTS NO.	INDEX	TYPE OR SPEC	Q'ty	REMARKS
5M01	2-E,4-F	669-4A822-0Y	1	
5M02	4-E	669-4H826-0Y	1	
5M03	6-C	669-2A827-0A	1	
6M04	2-E	693-2E413-0Y	1	
6M05	6-B	669-2A815-0C	1	
6M06	8-C	693-2E417-1A	1	
6M07	4-C	693-1A418-2Y	1	
5M11	6-E	FF-004	4	
5M12	4-D	KGLS-12RT	5	
1M40	3-E,4-E	661-4L020-0Y	2	
S121	2-D,4-F	BHM4×8-F-Z-K	14	
	5-E,6-E			
S122	5-D,8-C	BHM3×12-F-Z-K	4	
S110	6-C,7-B	BHM3×10-F-Z-K	2	
S123	3-D,4-A	BHM3×6-F-Z-K	33	
	4-D,5-A			
	5-C,6-E			
	7-B,7-C			
S124	7-B	BHM2.6×6-F-Z-K	2	
S111	7-C	BHM2.6×4-F-Z-K	2	
S125	7-C,8-C	BTB3×8-F-Z-K	8	
S064	5-D,6-C	N4-B-N	6	
	6-D			
S041	5-C,6-C	N3-B-N	5	
	7-D			
S059	6-C	SW4-B-N	4	
S039	5-C,7-C	SW3-B-N	4	
S060	6-D	W4-B-N	4	
S116	5-D,6-D	OW4-F-Z	2	
S040	6-C	OW3-F-Z	1	
S061	5-C	W3-B-N	3	
KNB1	2-F,3-E	2708303	4	
	3-F			
KNB2	2-E,3-E	2715603	2	
CAP1	2-E,2-F	3008134	2	RED
CAP2	2-E,2-F	3008135	2	BLUE
CAP3	3-E	3015132	2	GRAY
5M08	6-C	693-4A421-0Y	1	

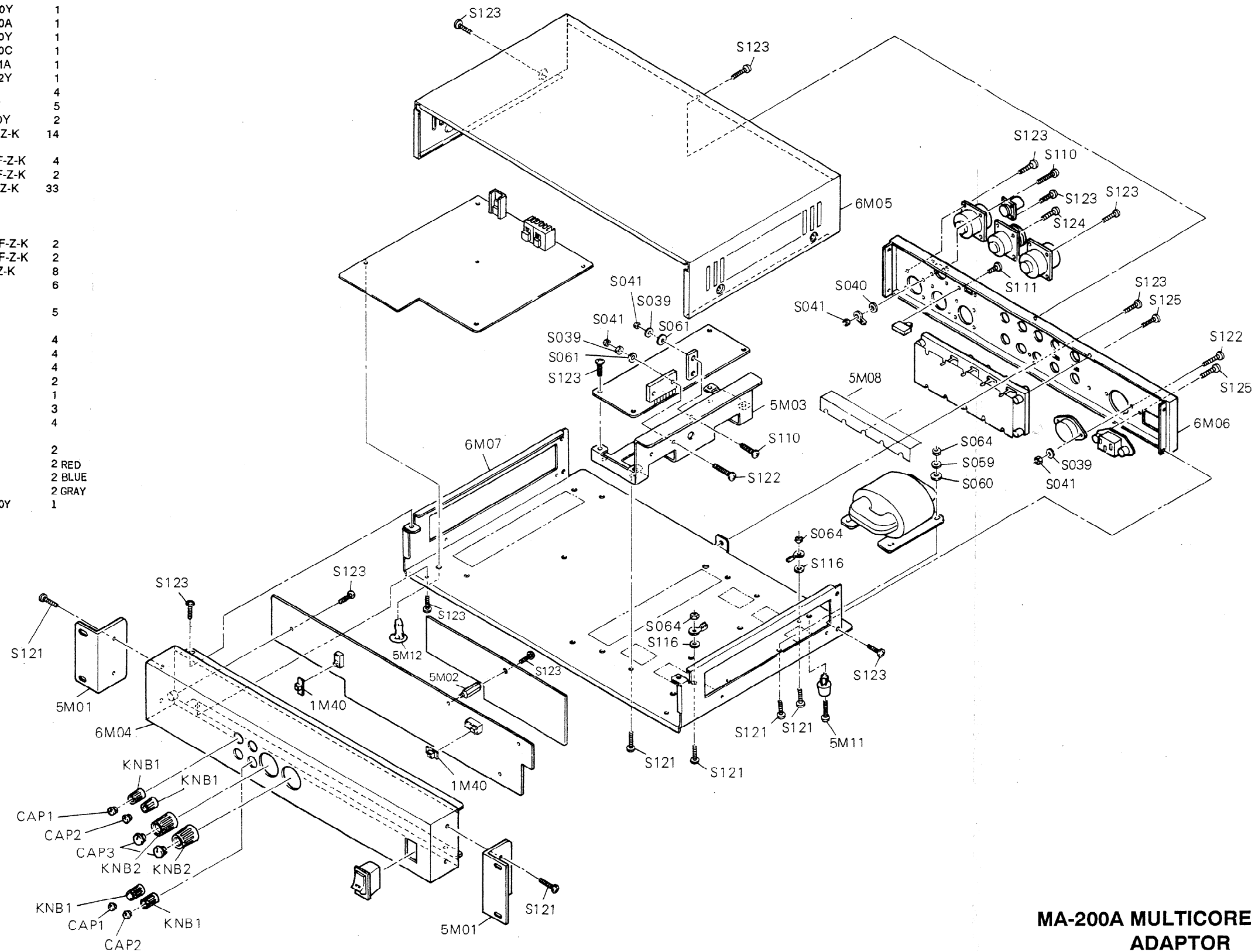

MA-200A MULTICORE CABLE ADAPTOR

693-3G408-1Y

IKEGAMI TSUSHINKI CO., LTD