

Ikegami IP Network MegaPixel Camera

IPD-BX110

Ikegami Provides the Best in Highly Sensitive Images and Reliability.

The IPD-BX110 is the latest addition to Ikegami's renowned stable of high sensitivity IP network camera, supporting the highly efficient H.264 and M-JPEG compression formats, which allows wider light spectrum coverage to the near infra-red spectrum to provide the optimal video quality required for Professional security systems.



IPD-BX110 Ikegami IP Network MegaPixel Camera

MEGA pixel **i**

High Resolution and Low Light Performance

The IPD-BX110 employs a newly developed 1/3-inch CMOS sensor to provide high resolution video images, coupled with High Sensitivity Performance of 0.5Lux/F1.2 for Colour (0.0015Lux/F1.2 for monochrome) providing clear picture reproduction in very low light conditions.

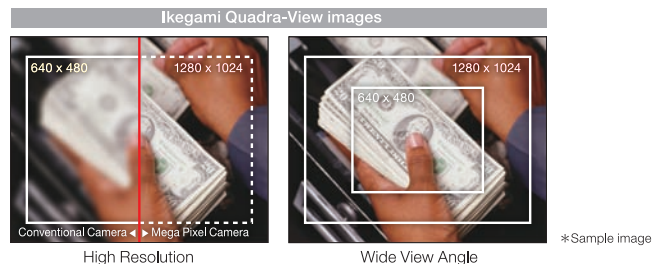

H.264 and M-JPEG Compatibility

The IPD-BX110 fully supports H.264/M-JPEG video compression and AAC audio compression. The highly efficient H.264 compression standard saves over 50% of the bandwidth and disk space required by MPEG-4.

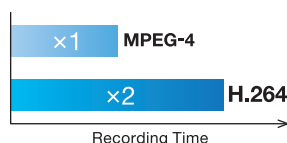

Equipped with Remote Back Focus Adjustment

The IPD-BX110 has a remote back focus adjustment feature with a well-designed electronic control mechanism.



SD card On-Board

An SD card slot interface is provided for on-board recording.

Video Motion Detection

Ikegami's unique algorithms permit accurate operation under poor conditions, including outdoor operation.

Focus EZ Function

Enables accurate focus adjustment with the best depth of field.

Service Analogue Video Output over BNC Connector

Power over Ethernet

Built-in Microphone with Wide Sensitivity

True Day/Night Changeover Function

SPECIFICATIONS

CAMERA	
Image Device	1/3" CMOS sensor
Scanning System	Progressive scan
Video Compression	H.264, M-JPEG
Codec Image Size (HxV)	1280x1024/640x480
Maximum Frame Rate	30fps
Minimum Illumination	0.5Lx/F1.2 (HYPER-AGC, IRE50%, Sens.up: OFF, Colour mode) 0.0015Lx/F1.2 (HYPER-AGC, IRE50%, Sens.up: x32, B/W mode)
Day/Night	Removable IR-cut filter
Frame Integration	Available (max. 32times) AUTO (S/N, STD, MOVE), Manual
Electronic Shutter Speed	1/30 - 1/30,000sec, FL (Flickerless)
Back Light Compensation	Available (ON/OFF/SPOT Level adj.)
Auto Gain Control (AGC)	ON (AGC, Hyper-AGC) / OFF (LOW, MID, HIGH)
White Balance	ATW1/ATW2/AWC/Manual
Privacy Masking	Available (up to 8areas)
Easy Focus	Available (Focus Indicator display)
Back Focus Adjustment	Available (Remote control)
Auto Iris Function	DC iris
Camera Setup	through Client PC or OSD menu
Lens Mount	CS-mount

Dimensions / Connectors

Unit:mm

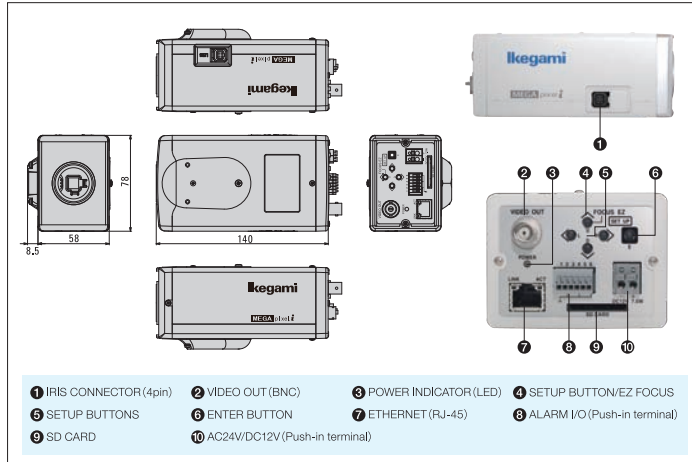

Related Products



VIDEO ANALYTICS	
Motion Detection Function	Available
AUDIO	
Audio Compression	ADPCM 32Kbps
Audio Input	Built-in microphone
ANALOGUE VIDEO OUTPUT	
Video Output	1ch (BNC) Composite
NETWORK	
Ethernet Interface	10BASE-T/100BASE-TX
Protocols	TCP, UDP, RTP/RTCP, RTSP, HTTP, FTP, DHCP, DNS, NTP (Multicast streaming)
VIDEO STORAGE	
Flash Memory	SD Card slot (Max. 32GB SDHC standard)
GENERAL	
Power Requirement	AC24V±10%/DC12V (10.5V-15V) / PoE (IEEE 802.3af) CLASS 0
Power Consumption	Approx. 7W
Ambient Temperature	-10°C - +50°C / 30-90%RH
Dimensions	W78xH58xD140mm
Weight	600g

This product is made of ECO friendly components based upon the Company policy and Corporate Social Responsibility to help Global Environmental solution for energy conservation and environmental sustainability, and all the components used in this product are Non-hazardous, Toxic Free, Non-Lead materials and parts conforming with Japan's Green Product Regulation, EU's RoHS Directive, and other environmental and hazardous chemical substances related regulations and laws.

Design and specifications are subject to change without notice.

Ikegami Tsushinki Co.,Ltd.

URL: <http://www.ikegami.co.jp/en/>

Head Office

5-6-16 Ikegami, Ohta-ku, Tokyo 146-8567, Japan TEL.03-5700-1111/FAX.03-5700-1137

Overseas Sales Division

5-6-16 Ikegami, Ohta-ku, Tokyo 146-8567, Japan TEL.03-5700-4117/FAX.03-5748-2200

Ikegami Electronics (Europe) GmbH URL: <http://www.ikegami.de>

Headquarters

Ikegami Strasse 1, D-41460 Neuss, Germany TEL.02131-1230/FAX. 02131-102820

U.K. Branch

Unit E1 Cologne Court, Brooklands Close, Windmill Road, Sunbury-on-Thames, Middlesex TW16 7EB, England TEL.01932-769700/FAX.01932-769710

Denmark Office

Horkær 7-9, 2730 Herlev, Denmark TEL.3880-9903/FAX.3881-9903



U187A109-HA Printed in Japan

